

REV.	LOCAS.	DESCRIPTION	DRAW.	DATE.
01	NEW	INITIAL RELEASE.	Junly	2010.08.16

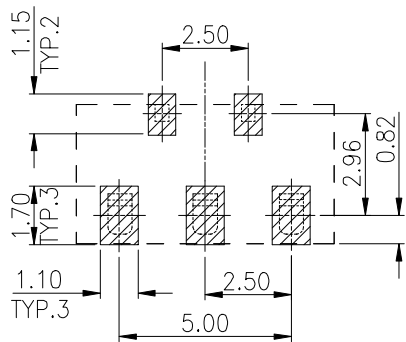
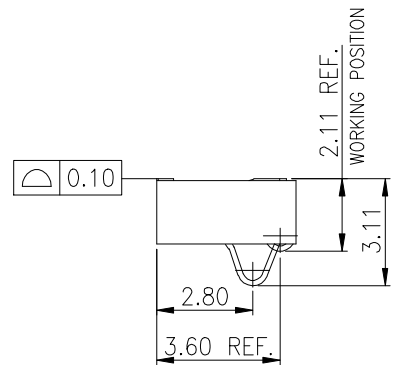
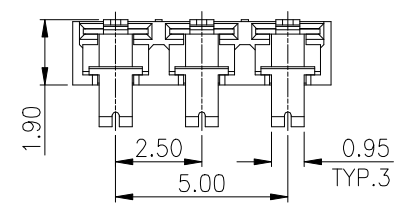
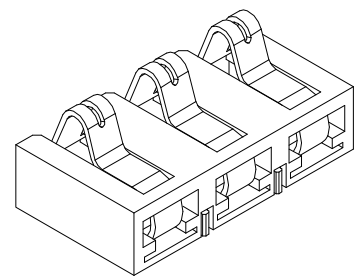
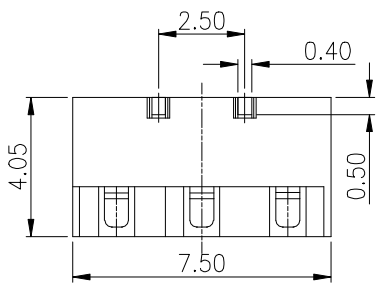

RECOMMENDED PCB LAYOUT
TOLERANCE: ±0.05

NOTES:

1. MATERIAL:
 - 1.1 Housing:High Temperature Thermoplastic UL94V-0; Color Black.
 - 1.2 Terminal:Copper Alloy.
 - 1.3 Stator:Copper Alloy.
2. SPECIALITY:
 - 2.1 Rated current:0.5A
 - 2.2 Rated voltage:30V
 - 2.3 Contact Resistance:50mΩ MAX
 - 2.4 Insulation Resistance:100MΩ MIN 100V DC
 - 2.5 Dielectric withstanding voltage: 100V AC.
 - 2.6 Solder ability:245±5℃, 5±0.5s.
 - 2.7 Durability:5000 Cycles Min.
 - 2.8 Operating condition:Temperature-30℃~+80℃; Humidity 80% R.H MAX

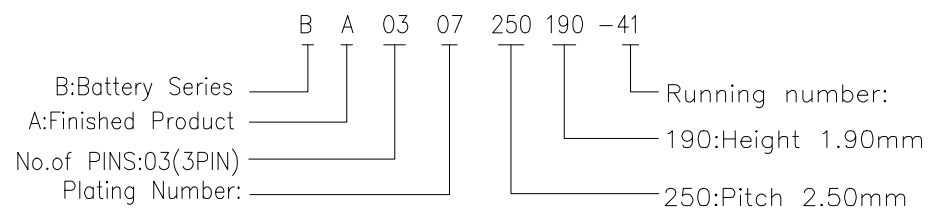

MEASURE POINT: QUADRANT POINT (QP) TANGENCY POINT (TP) INTERSECTION POINT (IP)	DongGuan D-CHAIN Precision Components CO, Ltd						
UNLESS OTHERWISE SPECIFIED, TOLERANCE:	DESING	Junly	DATE	2010.08.17	TITLE:		
X. ±0.25	CHECKED	Eric	DATE	2010.08.27	BATTERY 3PIN PH:2.5mm H:1.90mm		
X.x ±0.20	APPROVED	Eric	DATE	2010.08.27	SMT TYPE		
X.xx ±0.15	PART NO:	BA0307250190-41			REV: 01	SCALE: 5:1	UNIT: mm
ANGULAR ±3°	DRAWING NO:	DQBA0307250190-41			SIZE: A4	SHEET: 1/1	