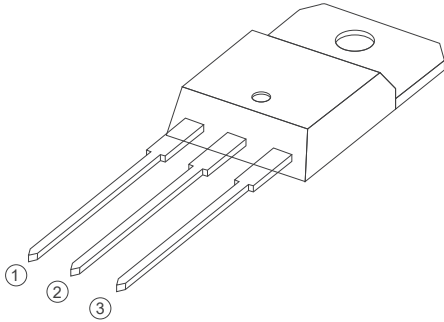
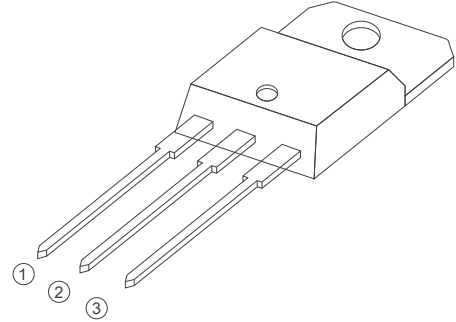


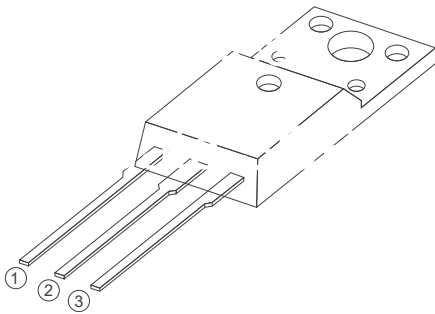
SCR1230/1630 Series  
30A SCRs  
Standard SCRs



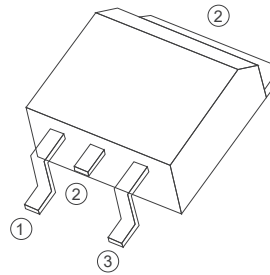
TO-220A Insulated



TO-220B Non-Insulated



TO-220F Insulated



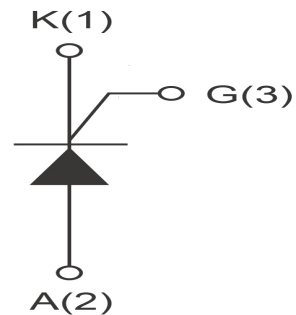
TO-263

## FEATURES

>  $I_T(RMS):30A$  >  $V_{GT}: 1.5V$  >  $V_{DRM} V_{RRM}:1200\sim1600V$

## APPLICATIONS

Washing machine,vacuums, massager,solid state relay, AC Motor speed regulation and so on.



**Absolute Maximum Ratings** (T<sub>j</sub>=25°C unless otherwise specified)

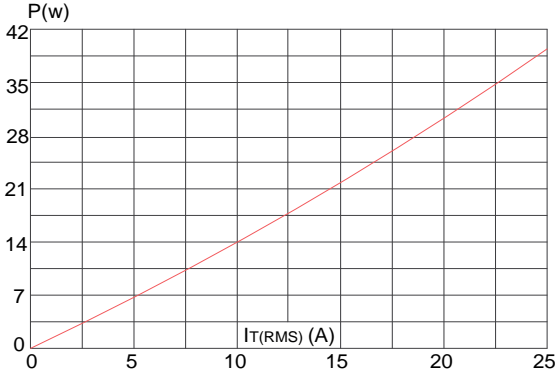
Symbol	Parameter	Conditions	Ratings	Unit
VDRM VRRM	Repetitive Peak Off-State Voltage	SCR1230	1200	V
		SCR1630	1600	
IT(RMS)	R.M.S On-State Current		30	A
ITSM	Surge On-State Current	F=50Hz, tp=10ms	330	A
I <sup>2</sup> t	I <sup>2</sup> t for fusing	tp=10ms	370	A <sup>2</sup> s
IGM	Peak Gate Current	tp=20us T <sub>j</sub> =110°C	1.5	A
PG(AV)	Average Gate Power Dissipation	T <sub>j</sub> =125°C	2	W
PGM	Peak Gate Current	T <sub>j</sub> =125°C	5	W
T <sub>j</sub>	Operating Junction Temperature		~40~125	°C
TSTG	Storage Temperature		~40~150	°C

**Electrical Characteristics** (T<sub>j</sub>=25°C unless otherwise specified)

Symbol	Parameter	Test Conditions	Value	Unit
IDRM	Repetitive Peak Off-State Current	T <sub>c</sub> =25°C	≤10	uA
		T <sub>c</sub> =125°C	≤4	mA
IRRM	Repetitive Peak Reverse Current	T <sub>c</sub> =25°C	≤10	uA
		T <sub>c</sub> =125°C	≤4	mA
VTM	Forward "on" voltage	I <sub>T</sub> =50A tp=380us	≤1.8	V
VGD	Gate nontrigger voltage	V <sub>D</sub> =VDRM, T <sub>j</sub> =125°C, R <sub>L</sub> =3.3KΩ	≥0.25	V
IL	Latching current	I <sub>G</sub> =1.2I <sub>GT</sub>	≤120	mA
IH	Holding current	V <sub>D</sub> =12V, I <sub>GT</sub> =0.1A	≤100	mA
VGT	Gate trigger voltage	V <sub>D</sub> =12V	≤1.5	V
IGT	Gate trigger current	V <sub>D</sub> =12V, I <sub>T</sub> =0.1A	≤40	mA
dv/dt	Critical-rate of rise of commutation voltage	V <sub>D</sub> =2/3VDRM, T <sub>j</sub> =110°C, R <sub>GK</sub> =1KΩ	≥1000	V/us
di/dt	Critical-rate of rise of commutation current	I <sub>G</sub> =2XIG, tr≤100us, T <sub>j</sub> =125°C	≥100	A/us
Rth(j-c)	Thermal resistance	Junction to case	2.3	°C/W

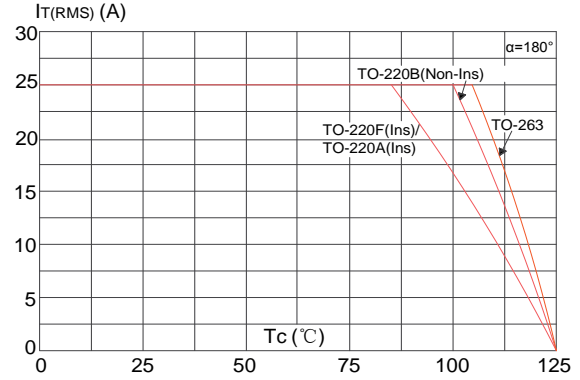
**FIG1**

Maximum power dissipation versus RMS on-state current



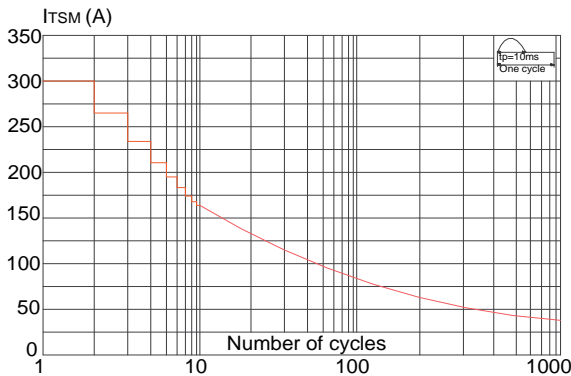
**FIG2**

RMS on-state current versus case temperature



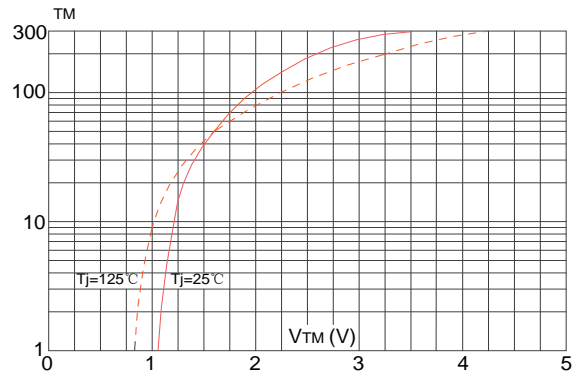
**FIG3**

Surge peak on-state current versus number of cycles



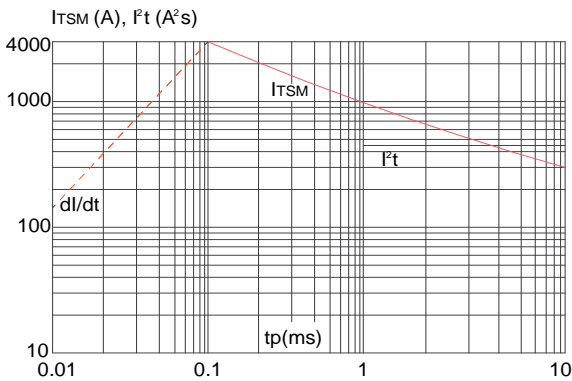
**FIG4**

On-state characteristics (maximum values)



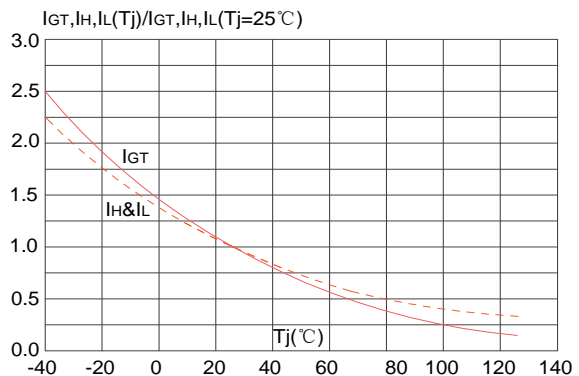
**FIG5**

Non-repetitive surge peak on-state current for a sinusoidal pulse with width  $t_p < 20\text{ms}$ , and corresponding value of  $I^2 t$  ( $di/dt < 100\text{A}/\mu\text{s}$ )

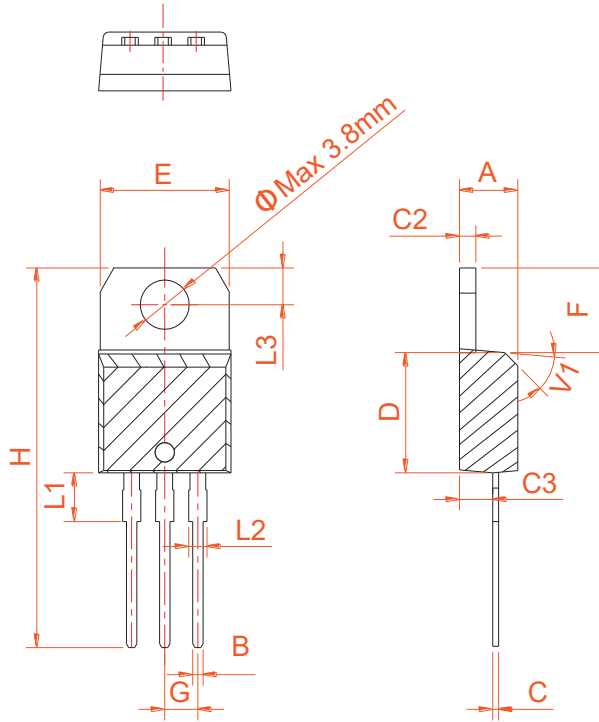


**FIG6**

**FIG.6:** Relative variations of gate trigger current, holding current and latching current versus junction temperature



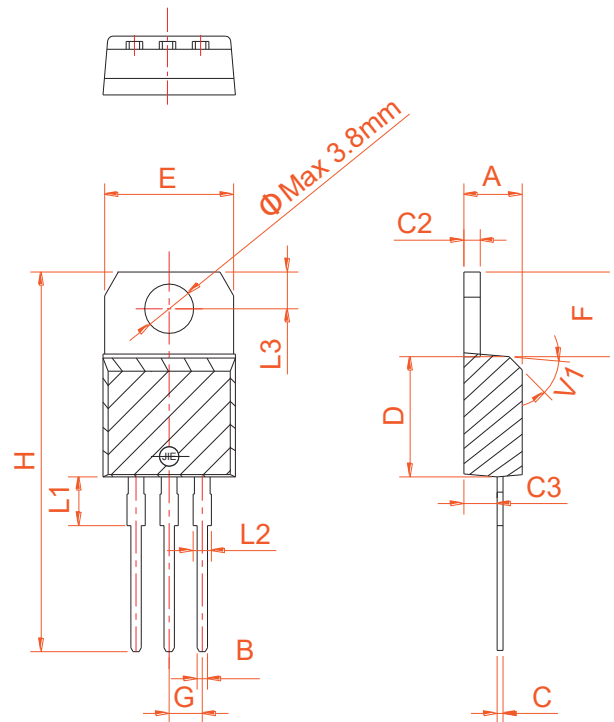
**PACKAGE MECHANICAL DATA**



TO-220A Ins

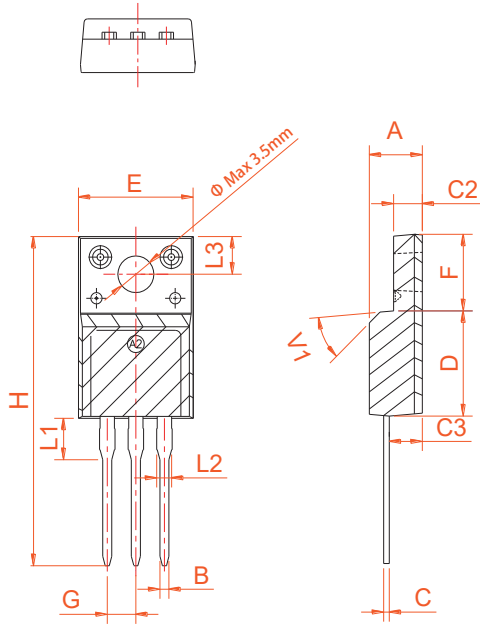
Ref.	Dimensions					
	Millimeters			Inches		
	Min.	Typ.	Max.	Min.	Typ.	Max.
A	4.40		4.60	0.173		0.181
B	0.61		0.88	0.024		0.035
C	0.46		0.70	0.018		0.028
C2	1.21		1.32	0.048		0.052
C3	2.40		2.72	0.094		0.107
D	8.60		9.70	0.339		0.382
E	9.80		10.4	0.386		0.409
F	6.55		6.95	0.258		0.274
G		2.54			0.1	
H	28.0		29.8	1.102		1.173
L1		3.75			0.148	
L2	1.14		1.70	0.045		0.067
L3	2.65		2.95	0.104		0.116
V1		45°			45°	

Ref.	Dimensions					
	Millimeters			Inches		
	Min.	Typ.	Max.	Min.	Typ.	Max.
A	4.40		4.60	0.173		0.181
B	0.61		0.88	0.024		0.035
C	0.46		0.70	0.018		0.028
C2	1.21		1.32	0.048		0.052
C3	2.40		2.72	0.094		0.107
D	8.60		9.70	0.339		0.382
E	9.60		10.4	0.378		0.409
F	6.20		6.60	0.244		0.260
G		2.54			0.1	
H	28.0		29.8	1.102		1.173
L1		3.75			0.148	
L2	1.14		1.70	0.045		0.067
L3	2.65		2.95	0.104		0.116
V1		45°			45°	



TO-220B Non-Ins

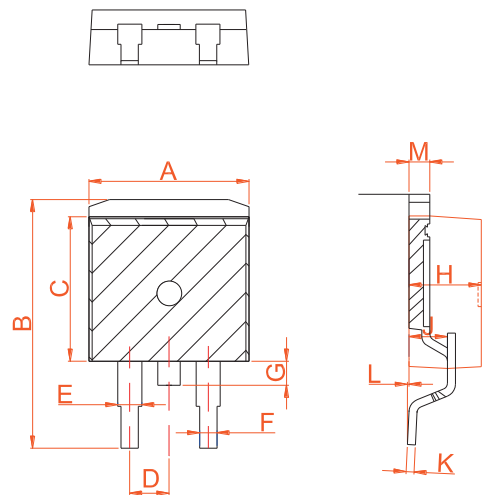
**PACKAGE MECHANICAL DATA**



TO-220F Ins

Ref.	Dimensions					
	Millimeters			Inches		
	Min.	Typ.	Max.	Min.	Typ.	Max.
A	4.50		4.90	0.177		0.193
B	0.74	0.80	0.83	0.029	0.031	0.033
C	0.47		0.65	0.019		0.026
C2	2.45		2.75	0.096		0.108
C3	2.60		3.00	0.102		0.118
D	8.80		9.30	0.346		0.366
E	9.80		10.4	0.386		0.410
F	6.40		6.80	0.252		0.268
G		2.54			0.1	
H	28.0		29.8	1.102		1.173
L1		3.63			0.143	
L2	1.14		1.70	0.045		0.067
L3		3.30			0.130	
V1		45°			45°	

Ref.	Dimensions					
	Millimeters			Inches		
	Min.	Typ.	Max.	Min.	Typ.	Max.
A	9.90		10.20	0.390		0.402
B	14.70		15.80	0.579		0.622
C	9.4		9.6	0.37		0.378
D		2.54			0.100	
E	1.20		1.40	0.047		0.055
F	0.75		0.85	0.029		0.033
G			1.75			0.069
H	4.40		4.70	0.173		0.185
J	2.30		2.70	0.091		0.106
K	0.38		0.55	0.015		0.022
L	0	0.10	0.25	0	0.004	0.010
M	1.25		1.35	0.049		0.053



TO-263



Information furnished is believed to be accurate and reliable. However, Shenzhen HanKingyuan Electronic assumes no responsibility for the consequences of use of such information nor for any infringement of patents or other rights of third parties which may result from its use. Specifications mentioned in this publication are subject to change without notice. This publication supersedes and replaces all information previously supplied.

The KY logo is a registered trademark of Shenzhen HanKingyuan Electronic.

©2013 Shenzhen HanKingyuan Electronic - Printed in Shenzhen - All Rights Reserved